

The background of the entire page is a dark blue, almost black, wood plank texture. The planks are horizontal and run across the width of the page. The wood grain is visible, with various knots and patterns. On the right side, there is a vertical dark grey rectangular area containing the text.

Res
ear
ch &
Des
ign

FACULTY WORK

The City College Of New York Bernard And Anne Spitzer School Of Architecture

Research & Design is dedicated to Bernard and Anne Spitzer in honor of their generous gift to The City College School of Architecture. We humbly acknowledge this gift as a vote of confidence in our school's mission, reflected in the exceptional faculty work represented here.





Res
ear
ch &
Des
ign

Faculty Work

The City College Of New York
Bernard And Anne Spitzer School Of Architecture



OSCAR RIERA OJEDA
PUBLISHERS

008 Message from the Dean

Works

012 George Ranalli
016 Peter Gisolfi
020 Jacob Alspector
024 Nandini Bagchee
028 Achva Benzinberg Stein
032 Maria Berman - Bradley Horn
036 Lance Jay Brown
040 Sara Caples

084 Denise Hoffman Brandt
088 Lewis Iglehart
092 David Judelson
096 Vanessa Keith
100 Fran Leadon
104 Fabian Llonch
108 Peter Lynch
112 Irma Ostroff
116 Ivan Rosa
120 Julio Salcedo-Fernandez

044 Mi-Tsung Chang
048 Timothy Collins
052 Johanna Dickson
056 Antonio Di Oronzio
060 Jeremy Edmiston
064 Alan Feigenberg
068 Alberto Foyo
072 Athanasios Haritos
076 Ghislaine Hermanuz
080 Ali Höcek

124 Michael Sorkin
128 Neal Spanier
132 Elisabetta Terragni
136 Albert Vecerka
140 Christian Volkmann
144 Lee Weintraub
148 June Williamson

Appendix

154 Faculty & Staff
156 Faculty Bios

Table of Contents

Message
from
The
Dean

The faculty of the Bernard and Anne Spitzer School of Architecture is poised between the theory and practice of architecture. In each case they have dedicated themselves to exploring the prevailing issues in the field in their built and project work while also staying firmly involved in the academic and theoretical realm of the architectural academy. The role of the practitioner/teacher is a model that goes back in history to the first moment architecture moved from the construction site to the school.

Architects who teach utilize the academy as a laboratory for their ideas based on experience first gathered from practice. Specific ideas that appear in some of the built and unbuilt works appear as studio projects where they can be explored more fully, often unencumbered by the practical realities of clients, budgets, and programs. The school is a perfect setting for the architect working in the field who brings professional acumen to the rarified experiments of the academic studio. This book, and accompanying exhibition, are the products of our faculty's professional work: vibrant, intellectually rich, professionally accomplished, and theoretically inclined. The work of the faculty of the Bernard and Anne Spitzer School of Architecture represents the perfect blend of rigorous academic ideas with the practical application of theories placed into the public realm.

George Ranalli

Dean

Bernard and Anne Spitzer School of Architecture

City College of New York

July 2009



Wo
rks

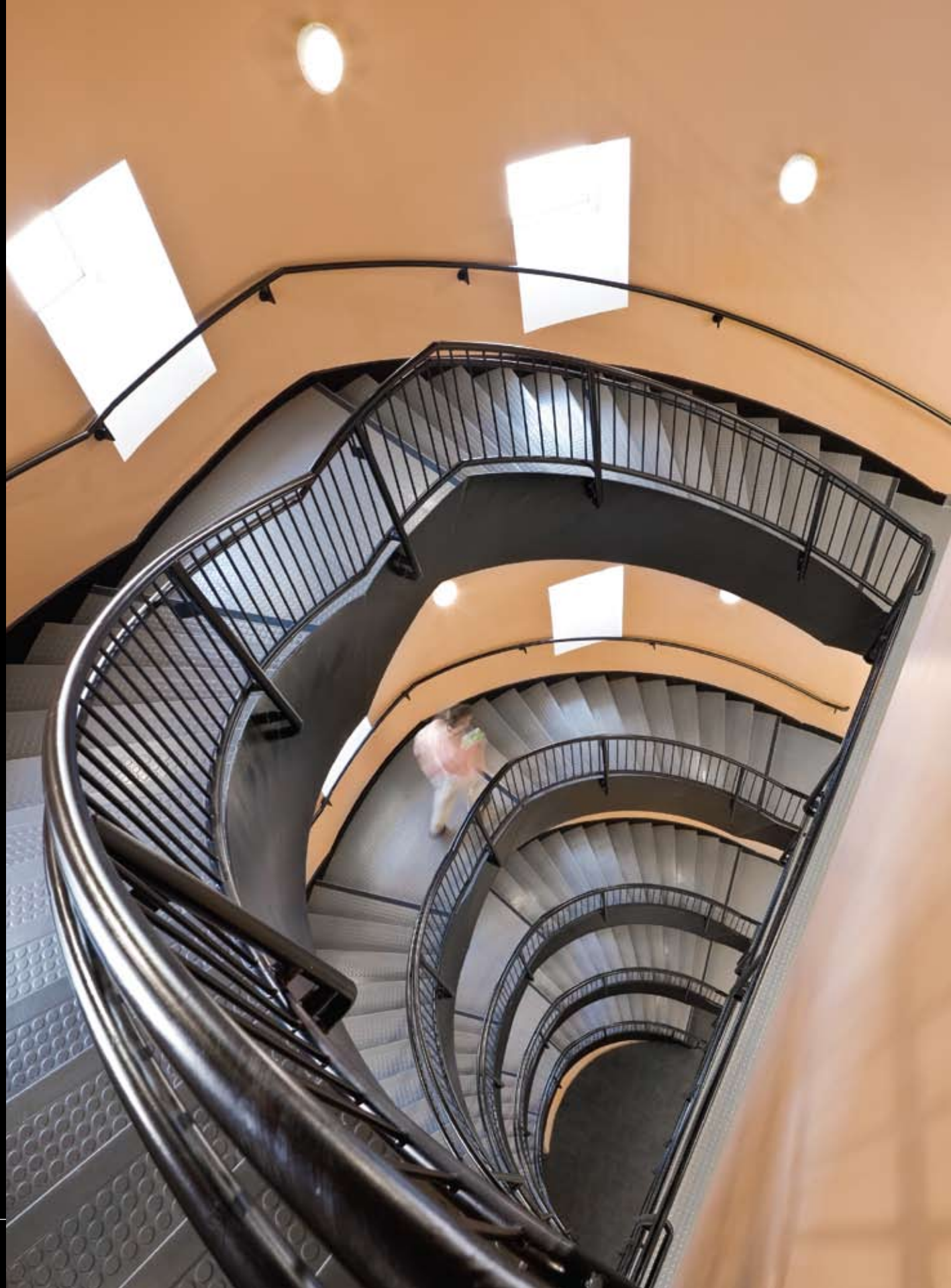



PHOTOS: ALBERT VECERKA / ESTO

Maria Berman Bradley Horn

Char No. 4
Cobble Hill, Brooklyn,
New York

description Char No. 4 is a southern-inflected restaurant and whiskey bar in a 19th century row house in Brooklyn. The name of the restaurant refers to the practice of burning the inside of oak barrels before the aging process, which gives whiskey its smoky flavor and traditional amber hue. The design takes inspiration from this tradition in its light, color, and in its nod to the form and construction of whiskey barrels both within the pattern of the façade and in custom designed light fixtures. • A field of large cylindrical pendants works tectonically to equalize the difference in height between the front and rear zones of the restaurant, acoustically to baffle sound in the crowded bar area, and atmospherically to suffuse the space with a tawny glow.

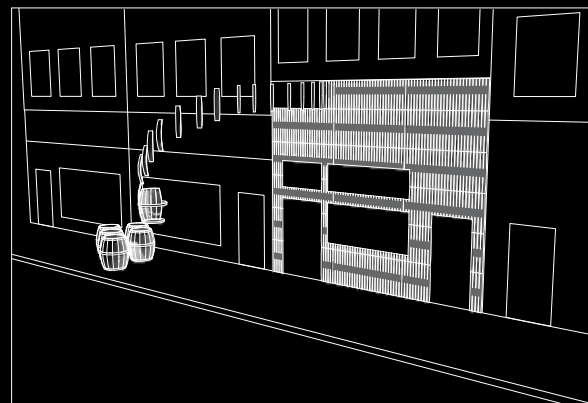
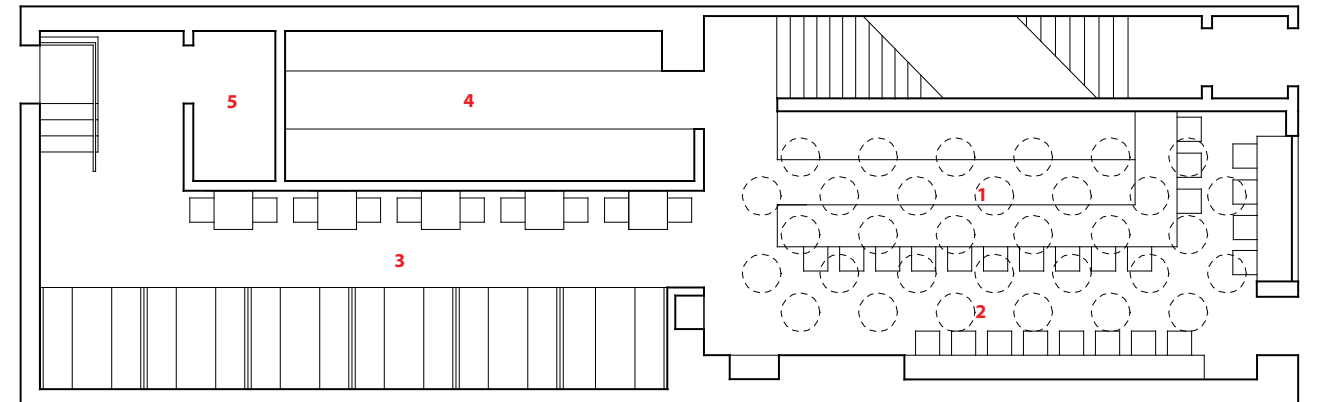
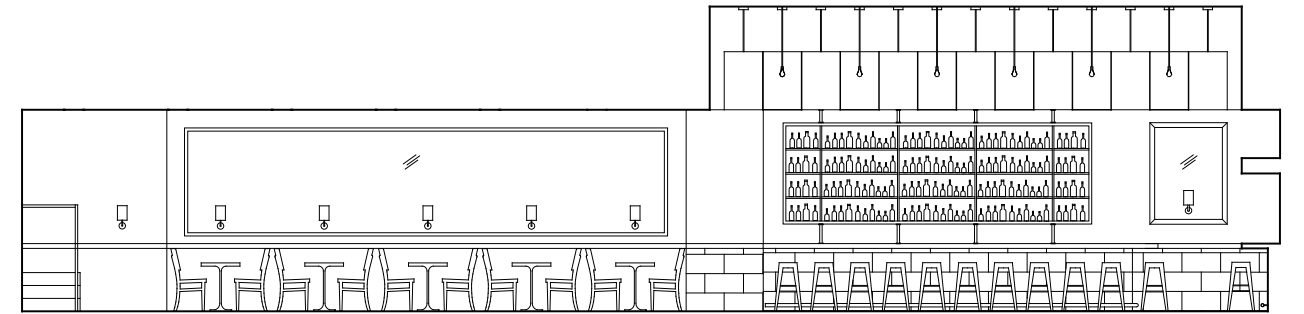
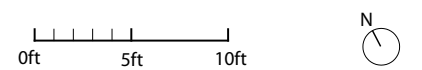

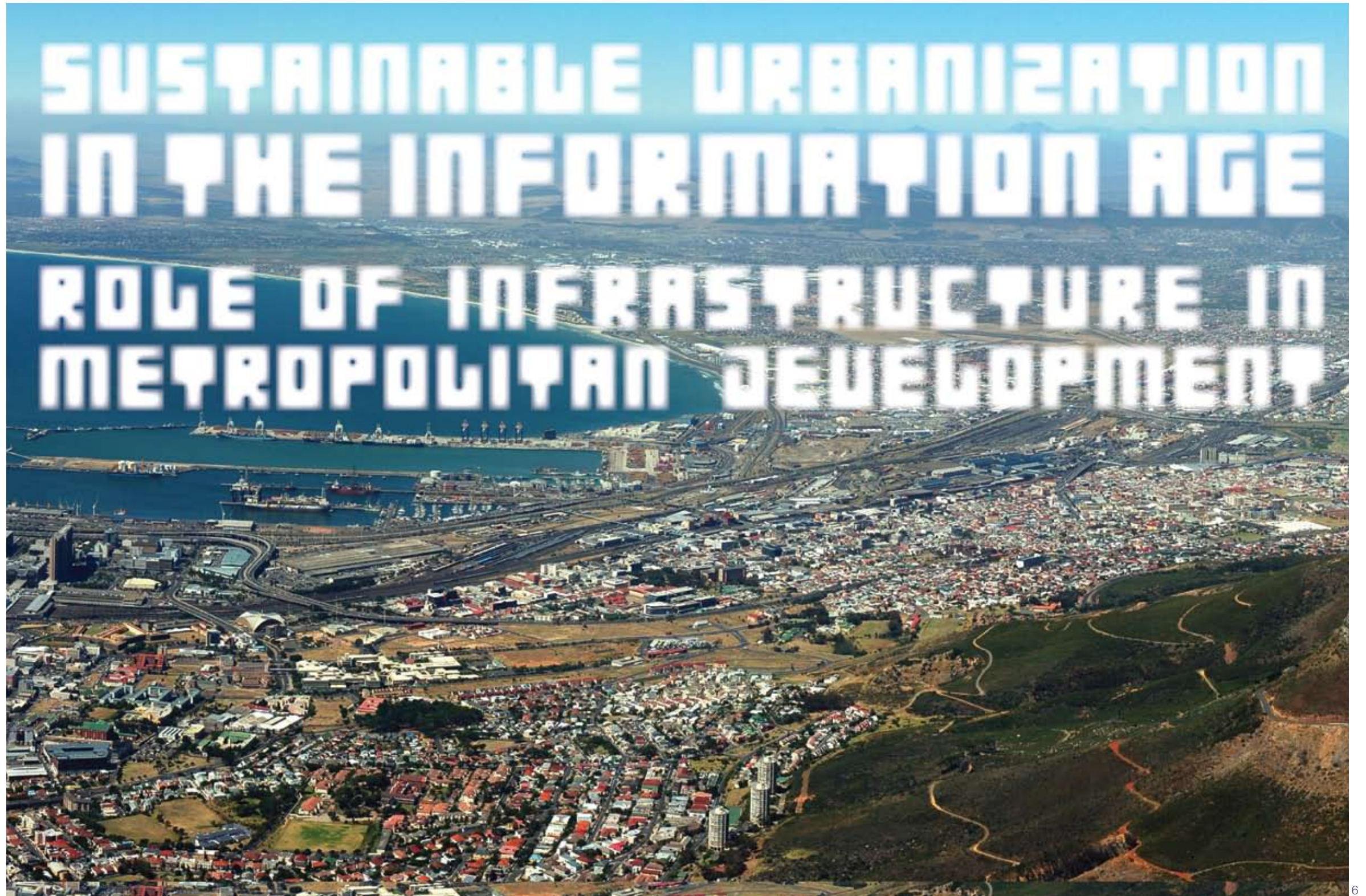

PHOTO: BERMAN HORN STUDIO



- 1. Bar
- 2. Front Seating Area
- 3. Rear Seating Area
- 4. Kitchen
- 5. Bathroom





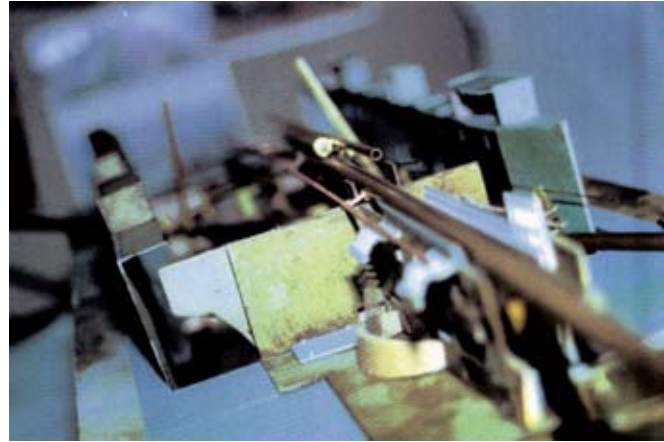
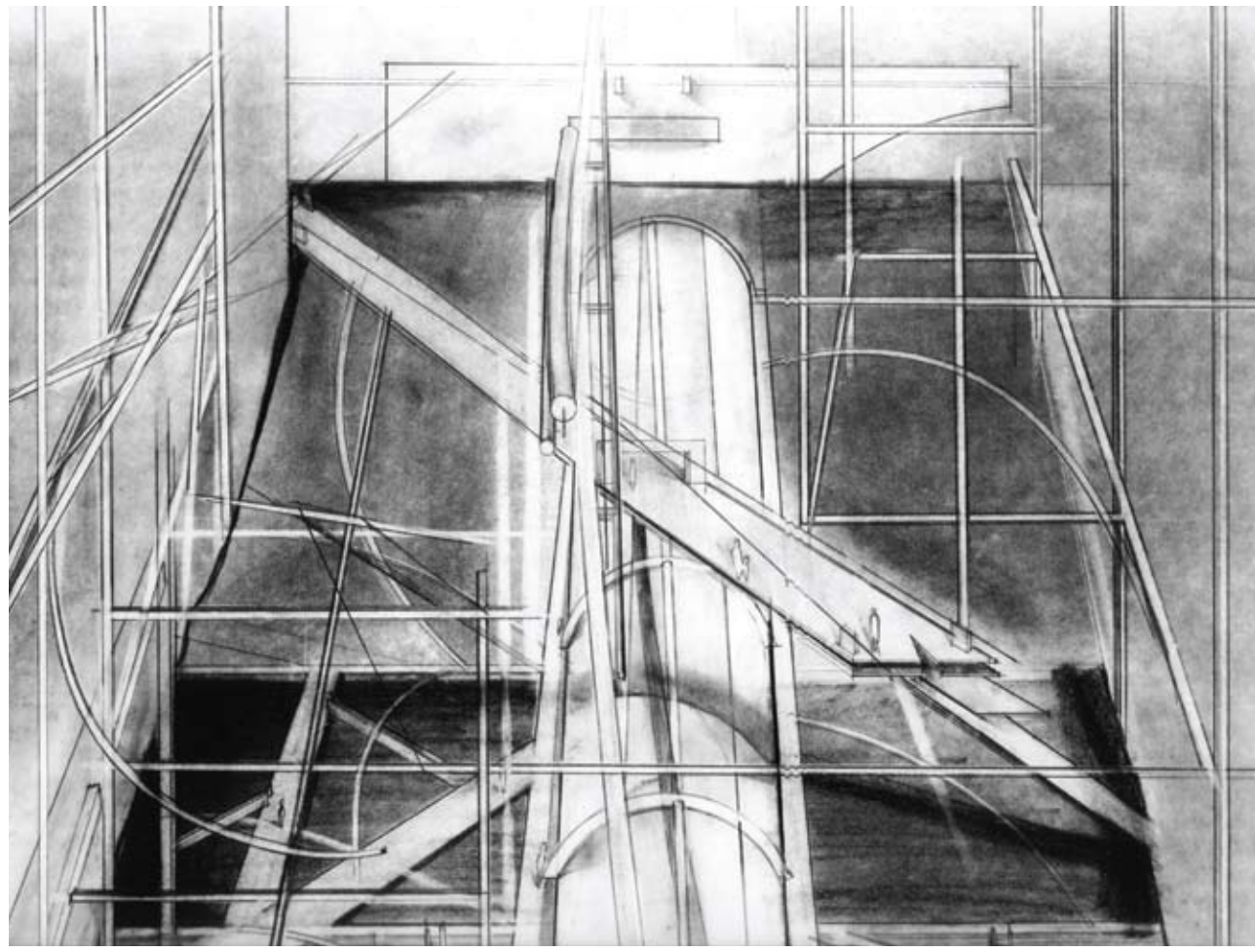
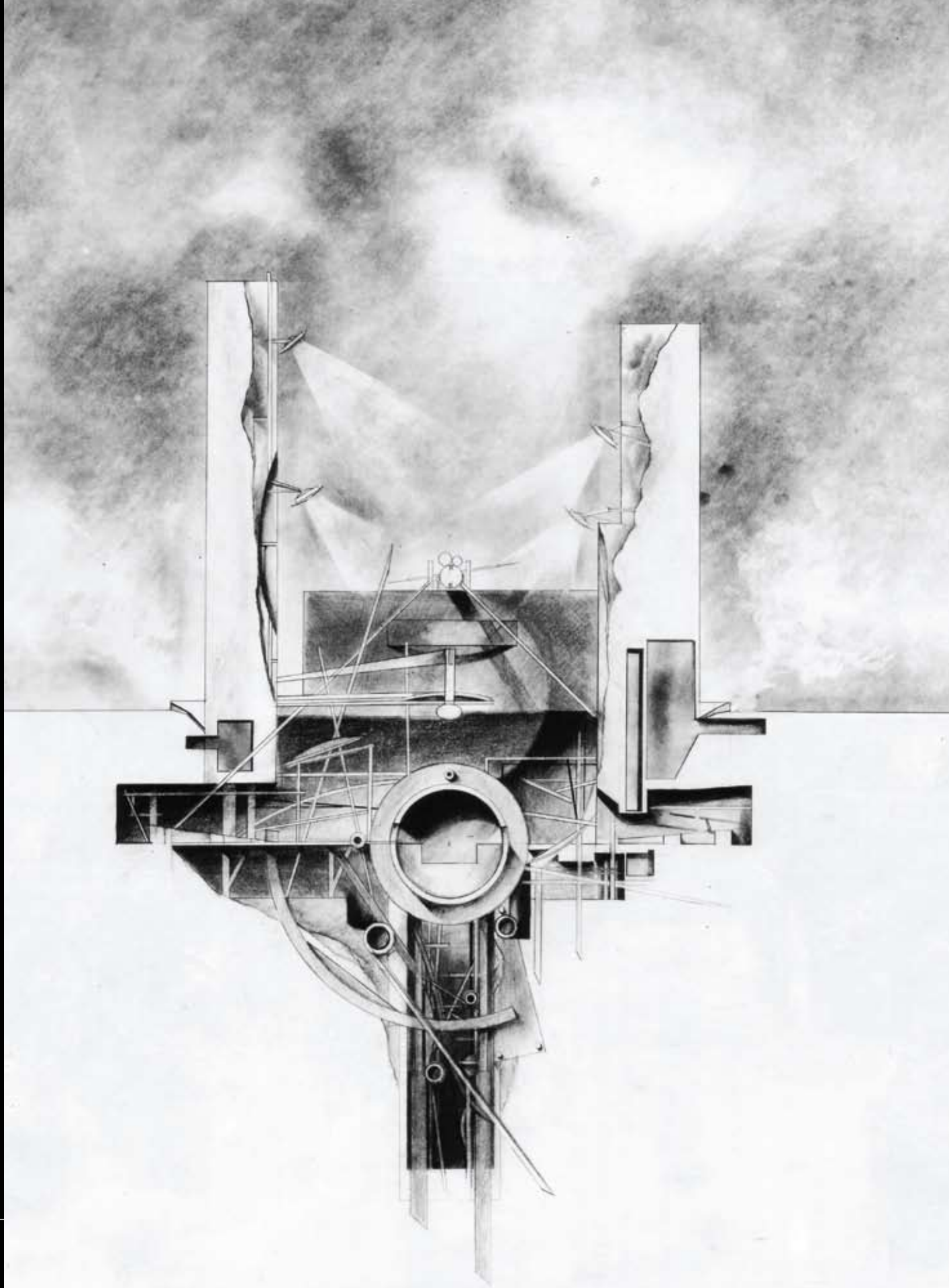



Athanasios Haritos

Achio House
San Jose, Costa Rica
In collaboration with Guillermo Garita

description Achio House is located in San Jose, Costa Rica, in the Rio de Oro residential development, a setting comprised of sporadic low-scale dwellings. The house sought to reconcile various factors of program, site and technology and to achieve a meaningful existence with its surroundings. A linear translucent bar defines and screens the south edge boundary line. A periphery wall secures the property and stabilizes the geometry of the site. The ground plan of the house is set in oblique orientation to the site and touches the north boundary wall, reconciling the plan to the property and recalling distant views of the context. A linear translucent bar defines and screens the south edge boundary line.



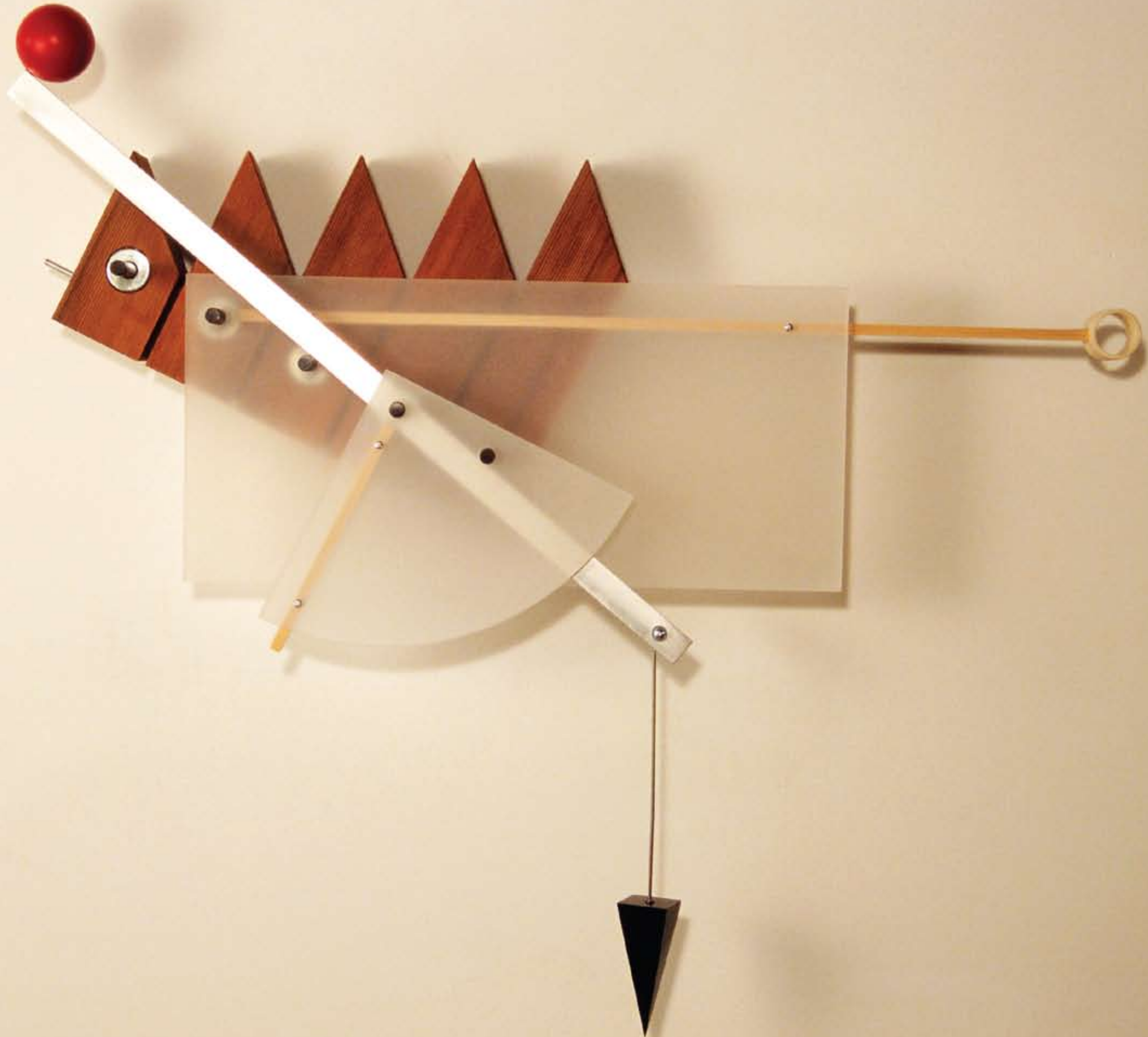





PHOTOS: SAM FENTRESS AND FABIAN LLONCH

Fabian Llonch

Rock Bridge Christian Church
Columbia, Missouri

description The program called for a new sanctuary, classrooms, and narthex to be built as an addition to two existing buildings. • The project became a free spirit occupying the space between the buildings, like a flowing wind contrasted against the rigidity of the existing structures. We proposed two arms, embracing the site, program, and community: one arm (the sanctuary) at the same level as the main entrance and a second arm (the classrooms) sloping down with the existing topography. As a site strategy, two exterior pathways will run through the site, like rivers, as an open invitation for different people to gather. The blending of the pathways with the new building will create two distinct outer spaces.



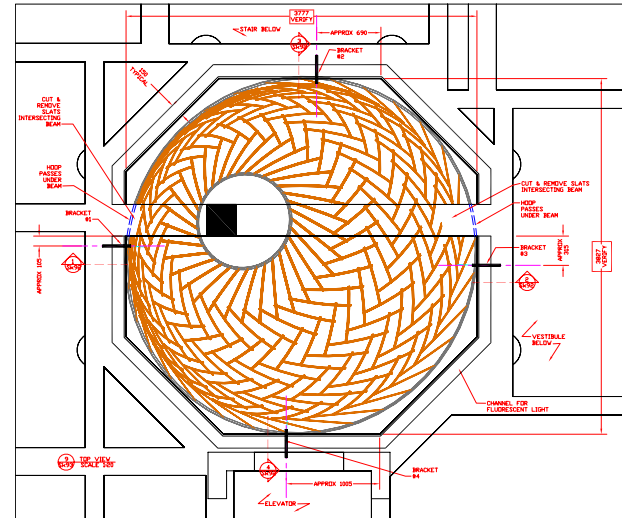





MICHAEL DOLINSKI (LEFT AND RIGHT)

Elisabetta Terragni

Kindergarten and
Elementary School
Altavilla Vicentina, Italy

description In addition to the kindergarten and elementary school, the building accommodates a gymnasium, Mensa, and community auditorium. Classrooms are grouped together in the south and north of the building, its ample vestibule providing an elevated play and study area over a subterranean theater. Classrooms have individual patios shielded by movable sunscreens. And in combination with patios and corridors form an enticing maze containing bathrooms, storage, and recreation areas. • The concept of the building resides in an extended single-story structure. Three distinct entrances lead to the classrooms of the kindergarten and elementary school, as well as to a sunken auditorium.



PHOTOS: ELISABETTA TERRAGNI (EXCEPT WHERE NOTED)





IMPOSSIBLE IS JUST A BIG WORD THROWN AROUND BY SMALL MEN WHO FIND IT EASIER TO LIVE IN THE WORLD THEY'VE BEEN GIVEN THAN TO EXPLORE THE POWER THEY HAVE TO CHANGE IT. IMPOSSIBLE IS NOT A FACT. IT'S AN OPINION. IMPOSSIBLE IS NOT A DECLARATION. IT'S A DARE. IMPOSSIBLE IS POTENTIAL. IMPOSSIBLE IS TEMPORARY.

IMPOSSIBLE IS NOTHING.

FOREVER SPORT 

Christian Volkmann

Nine Square House
Germany

description Planned for a work-at-home couple with their own small marketing firm, this house on the edge of a farming town had to fulfill the client's request for a short construction time and maximum spatial flexibility, and take full advantage of germany's extensive 'green building' subsidies.

- The clients wanted the house's image to correspond to the local barn and farmhouse-dotted landscape. At the same time, they had always been fascinated by open loft-like spaces.
- The house is conceived as a full timbered, prefabricated structure, wrapped in a 14" insulated shell. The structural concept offers quick construction and 'flowing space' which can be subdivided as needed.

